



STANDARD OPERATING PROCEDURES

F5 MFG MBS TAILHOOK INSTALLATION INSTRUCTIONS

PURPOSE:

The following are the steps needed to install the tailhook brace onto the F5 MFG Modular Brace System (MBS)

SCOPE:

This document is specific for the Tailhook brace, but can be applied to any brace designed for a AR 15 buffer tube.

WARNING:

- Before performing any alterations to your firearm, ensure it is unloaded and clear
- Wear eye protection as some components are under spring tension
- Use the tools provided in your kit to ensure proper installation

This document applies to the following SKU:

F5-MBSCZCLATH-BLK	MODULAR BRACE SYSTEM FOR CZ SCORPION WITH TAILHOOK - BLACK
F5-MBSMP5CLATH-BLK	MODULAR BRACE SYSTEM FOR MP5 WITH TAILHOOK - BLACK
F5-MBSSP9A1CLATH-BLK	MODULAR BRACE SYSTEM FOR STRIBOG WITH TAILHOOK - BLACK
F5-MBSBTCLATH-BLK	MODULAR BRACE SYSTEM FOR B + T WITH TAILHOOK- BLACK
F5-MBSCZB2CLATH-BLK	MODULAR BRACE SYSTEM FOR CZ BREN 2 WITH TAILHOOK - BLACK

ITEMS NEEDED:

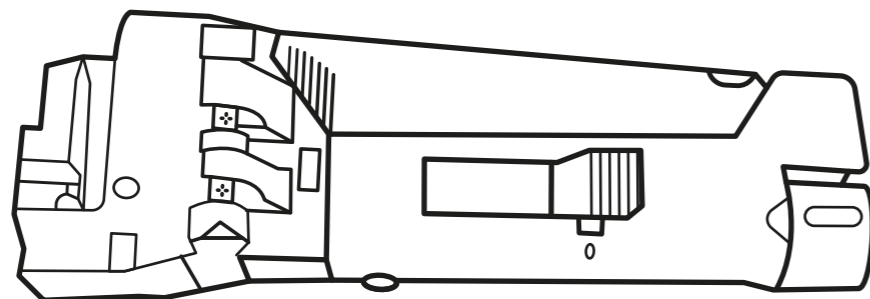

1. F5 MFG Modular Brace System

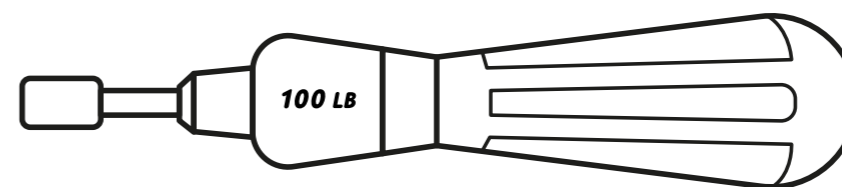

3. Torque driver (10 in-lbs capable)

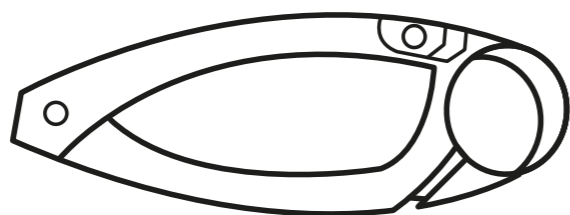

2. Tailhook brace



4. 3/32 driver bit

TAILHOOK INSTALLATION

1. Retrieve your torque driver.

- a. Set the torque to **10 in/lbs.**
- b. Install the **3/32 Driver Bit** into the torque driver.

2. Retrieve your F5 MFG MBS.

3. Retrieve your Tailhook Brace.

Ensure the attachment screws on the Tailhook are loose.

4. Place the Tailhook onto the round brace attachment boss on the MBS.

- a. Depending on the shooter preference, ensure the brace is oriented to open for a left or right handed shooter (right hand shown)
- b. Slide the brace fully onto the MBS boss until it is flush.

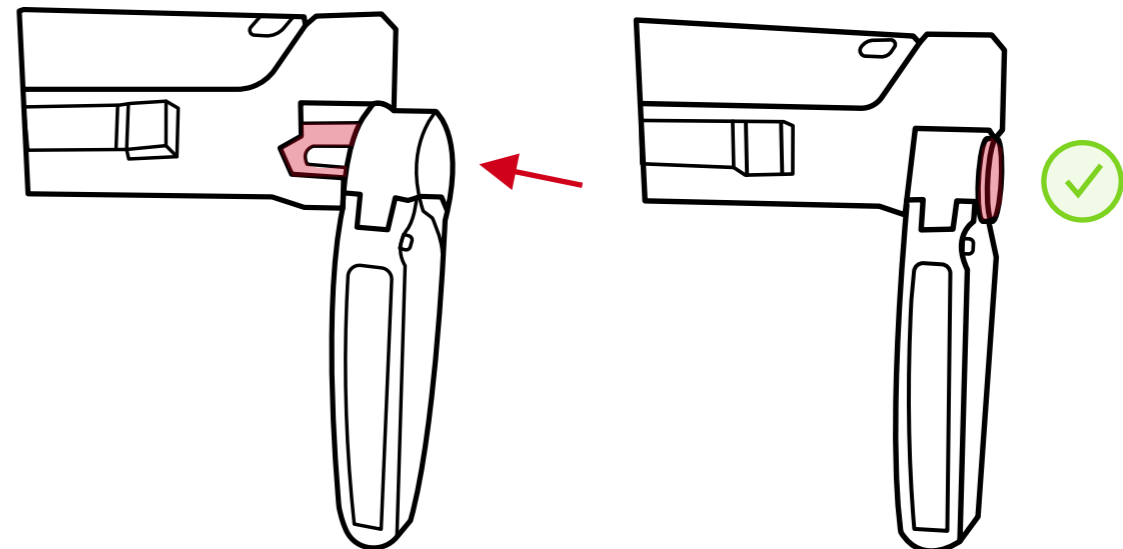

5. Ensure the brace is aligned with the MBS

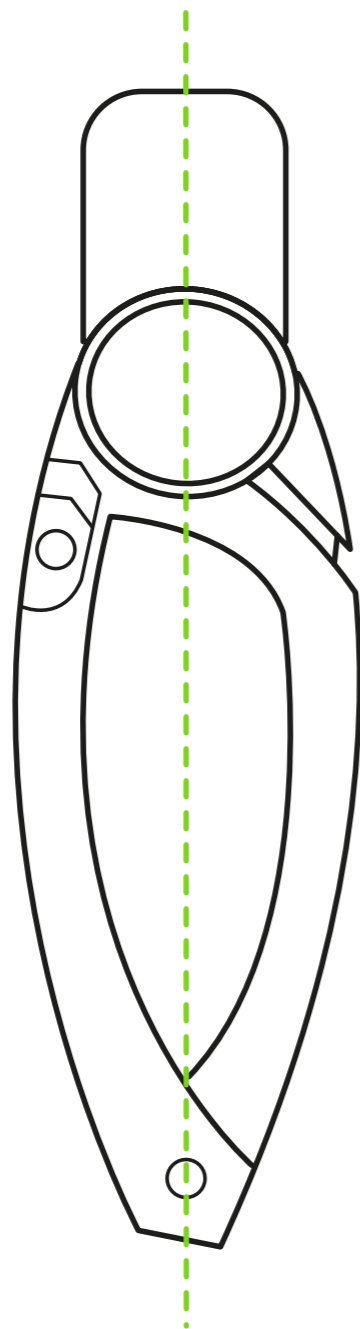

6. Tighten both attachment screws

Torque both screws to **10 in-lbs**

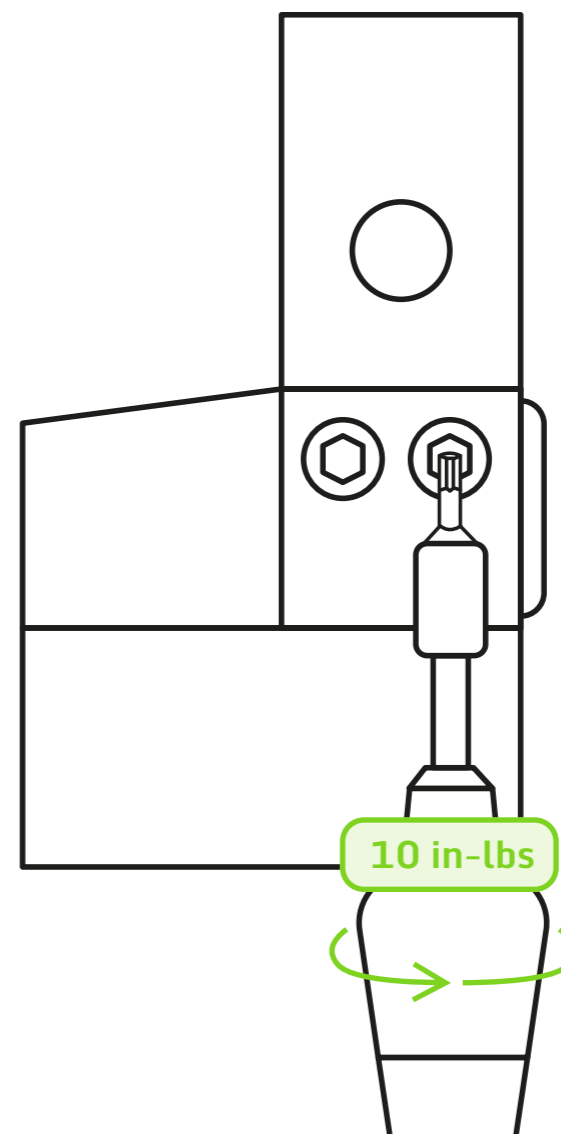

YOUR TAILHOOK IS FULLY INSTALLED AND READY TO USE!

